



Cubix Apartments, 42 Violet Road, E3 3QG
£2,000 PCM

coopers
OF LONDON EST. 1986

Cubix Apartments, 42 Violet Road, E3

- Available 12th August
- Close to transport links
- Key phone entry
- Unfurnished
- Double Bedrooms

Situated in a modern building, this 2 bed apartment offers easy access to the lush Brock Place Gardens and Limehouse Cut. Stylish open plan living leads onto a private balcony with picturesque suburban views.

The Cubix Building is centrally located near green spaces such as Langdon Park, Three Mills Park and The Olympic Park. It is also a short distance from Devons Road (DLR), Langdon Park (DLR) and Bromley-by-Bow tube stations

Situated in a modern building, this 2 bed apartment offers easy access to the lush Brock Place Gardens and Limehouse Cut. Stylish open plan living leads onto a private balcony with picturesque suburban views.

The Cubix Building is centrally located near green spaces such as Langdon Park, Three Mills Park and The Olympic Park. It is also a short distance from Devons Road (DLR), Langdon Park (DLR) and Bromley-by-Bow tube stations





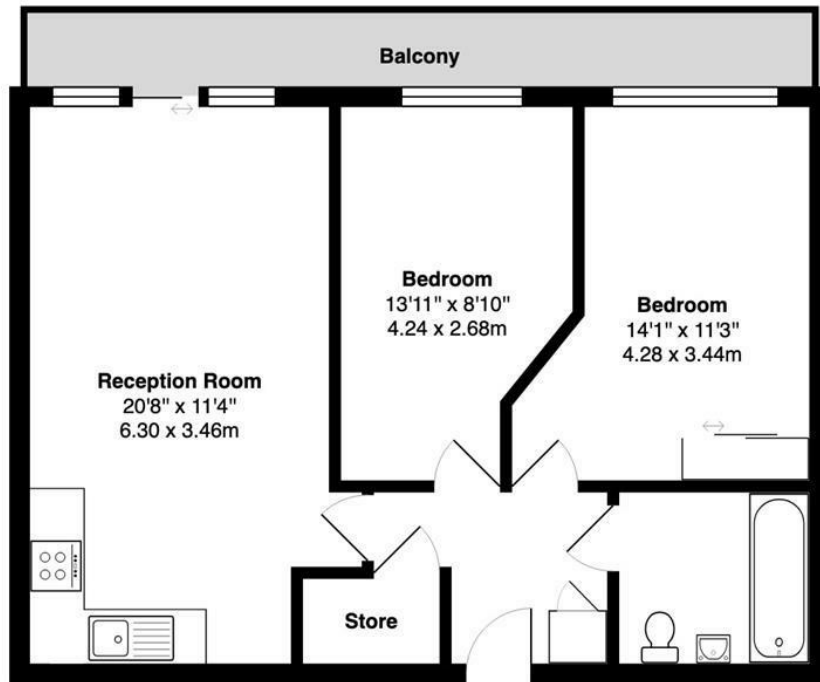

5th floor

Cubix Apartments Violet Road E3

Total Gross Area: 625 ft² ... 58.1 m² (excluding balcony)

All measurements are approximate and for identification guideline purposes only, not to scale.
Compliant with the RICS code of measuring practice

Energy Efficiency Rating		Current	Potential
Very energy efficient - lower running costs			
(92 plus) A			
(81-91) B			
(69-80) C			
(55-68) D			
(39-54) E			
(21-38) F			
(1-20) G			
Not energy efficient - higher running costs			
England & Wales		76	76
		EU Directive 2002/91/EC	

Environmental Impact (CO ₂) Rating		Current	Potential
Very environmentally friendly - lower CO ₂ emissions			
(92 plus) A			
(81-91) B			
(69-80) C			
(55-68) D			
(39-54) E			
(21-38) F			
(1-20) G			
Not environmentally friendly - higher CO ₂ emissions			
England & Wales			
		EU Directive 2002/91/EC	

Viewing

Strictly by appointment with:
Coopers of London, 22 Cleveland Street,
Fitzrovia, London W1T 4JB
info@coopersonlondon.co.uk

0207 580 9658

These particulars, whilst believed to be accurate are set out as a general outline only for guidance and do not constitute any part of an offer or contract. Intending purchasers should not rely on them as statements or representation of fact, but must satisfy themselves by inspection or otherwise as to their accuracy. No person in this firm's employment has the authority to make or give any representation or warranty in respect of the property.